

SWITCHING AC ADAPTER

GF65I-US<sub>TYPE</sub>



**DESCRIPTION:**

- 65W AC/DC Adapter
- Universal Input
- Desktop Type (IEC 320 C14)
- Power Saving < 0.5 W

**MEET SAFETY:**

CB, PSE, UL,cUL, FCC,CE,CEC

**GENERAL SPECIFICATIONS:**

Maximum Output Power:	65W
Input Voltage:	90~264VAC
Input Frequency:	47Hz~63Hz
Input Current:	1.35A
Leakage Current(max):	0.75mA
Efficiency:	80%
Ripple Noise(max):	240mVp-p
Line Regulation:	±1%
Load Regulation:	±5%
Hold-Up Time:	10ms
Over Voltage Protection:	120%
Over Current Protection :	120%~200%
Operating Temperature:	0~40℃
Operating Relative Humidity :	20~95%RH
Storage Temperature:	-20~80℃
Storage Humidity:	20~95%RH
Withstand voltage:	3KVAC/min
Weight:	300g
Cable type:	UL2468 16AWG or 18AWG

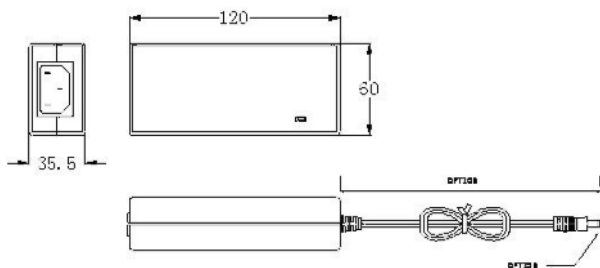

**Dimensions:**

**LxWxH:120x60x35.5 (mm)**

Model	INPUT	OUTPUT
<a href="#">GF65I-US1250</a>		12V.....5.0A
<a href="#">GF65I-US1543</a>	90-264VAC	15V.....4.3A
<a href="#">GF65I-US1640</a>	(50-60HZ)	16V.....4.0A
<a href="#">GF65I-US1836</a>		18V.....3.6A
<a href="#">GF65I-US1934</a>		19V.....3.4A
<a href="#">GF65I-US2032</a>		20V.....3.25A
<a href="#">GF65I-US2427</a>		24V.....2.7A

**GO FORWARD ENTERPRISE CORP.**

**Head Office:**

NO.328, Siangyang Road, Fongyan City,  
 Taichung County 420, Taiwan R.O.C

TEL:04-2529-2612 FAX:04-2529-2614

E-mail:sevice@goforward.com.tw / sales@goforward.com.tw

http:// [www.goforward.tw](http://www.goforward.tw) / [www.goforward.tw/jp](http://www.goforward.tw/jp)